

HALKEY ROBERTS AUTO RE-PACKING INSTRUCTIONS:

(AUTO - Hydro 1F V95000)

Ensure you have re-armed the PFD according to the previous instructions and all firing indicators are green.

1. Deflate the PFD by reversing the oral tube cap and pushing into the end of the oral tube.
2. Expel all air by tightly rolling up the bladder, repeat the procedure at least once to ensure all air is expelled. Replace cap in its normal position.
3. Ensure PFD is clean and completely dry.
4. Enclose CO₂ Cylinder and inflator body in protective sheath provided.
5. Lay bladder and cover on a flat surface, smooth out the bladder to remove all wrinkles.
6. Using the fold lines 1 to 4 as a guide, fold sides of bladder under and close velcro at sides ensuring pull cord is exposed once closed.
7. Velcro harness back strap in place on the cover.
8. Using fold lines 5 & 6 as a guide, fold top of bladder over and close velcro at top of cover to complete the repacking.

LJS

Life Jacket Solutions

MODEL T150MA AND G150MA AUTO (LEVEL 150)

HALKEY ROBERTS USER LEAFLET

(AUTO - Hydro 1F V95000)

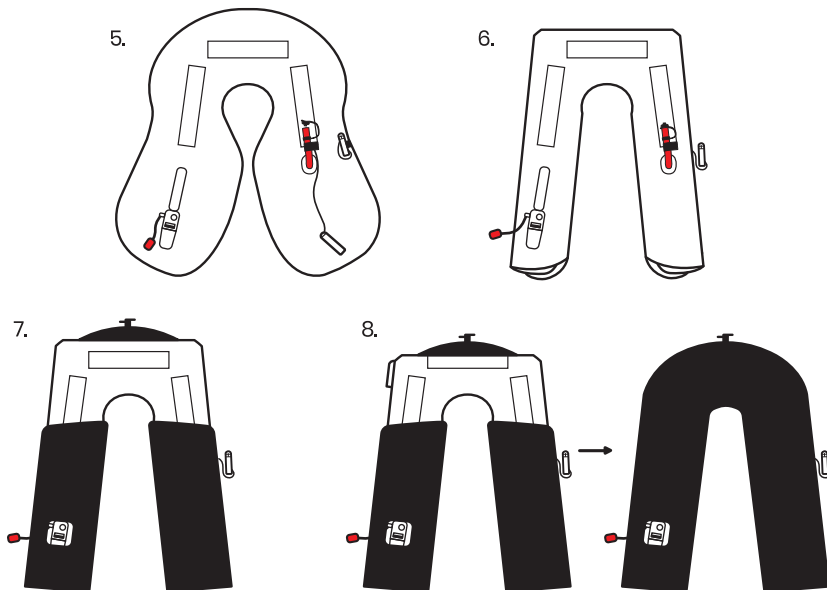
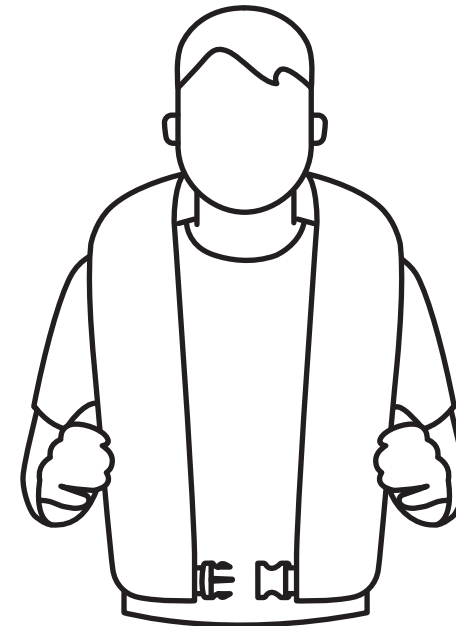

USER LEAFLET FOR HALKEY ROBERTS MODELS:

(AUTO - Hydro 1F V95000)

Please keep copy of your purchase receipt and mark on the service grid date of purchase.

PRE WEAR CHECK before every use:

1. Visually inspect for damage.
2. Check CO₂ cylinder for correct weight and screwed in hand tight.
3. Check on the Automatic jackets that the Automatic cartridge is screwed on hand tight.
4. Once all screwed in the indicator should be green. This is for both manual and auto versions.
5. Make sure pull cord is accessible when PFD is worn.
6. Refer to instructions if CO₂ bottle is empty/used or the indicator is red.

CARE AND MAINTENANCE

The life of this inflatable will be prolonged if the jacket is checked as per the care instructions.

After every use:

Wash your jacket in warm soapy water, rinse and dry.
Hang or store in ventilated position out of the sun light or harmful chemicals.
For Automatic remove the cartridge before the wash is done then screw back on before use.

Every 5-6 months:

1. Inspect CO₂ bottle for corrosion or damage.
2. Inspect bladder for signs of abrasion or wear and tear.
3. Inspect all outer fabric, buckles, webbing, stitching for wear and tear.
4. Inflate bladder by using oral tube. Blow up and leave overnight. Inspect for any loss of air.
5. If there are signs of corrosion, wear, damage or leaks as described above contact one of our professional service agents. **NEVER TRY TO REPAIR YOUR PFD YOURSELF.**

Annual Check:

This PFD can be self-serviced. It must be serviced within every 12 months either by self-service or through a professional service agent. The self service form can be downloaded at www.ljss.com.au

This PFD can be self-serviced every 12 month for 5 years before it has to be serviced by a professional service agent.

For professional use the jacket must be serviced every 12 months by a professional service agent.

HALKEY ROBERTS AUTO RE-ARMING INSTRUCTIONS:

(AUTO - Hydro 1F V95000)

DISASSEMBLY (SEE FIGURE)

STEP 1: Unpack or open the life vest so that the manual/automatic inflator is visible.

STEP 2: Remove gas CO₂ cylinder by rotating cylinder counterclockwise then pull out. Discard cylinder.

STEP 3: Remove cap by turning counter-clockwise.

STEP 4: Remove bobbin from cap or housing unit. Discard bobbin (Yellow). Check the housing to be sure it is clear and dry.

Note: The bobbin (Yellow) body may remain in the housing unit or in the cap assembly when you remove the cap. The bobbin body must be removed prior to Rearming.

RE-ARMING

NOTE: Rearming must follow the sequence below.

STEP 5: A new bobbin must be used. New bobbin must have been purchased within three (3) years. If bobbin purchase date is unknown, check date on bobbin, replace if over three (3) years.

STEP 6: IMPORTANT! Bobbin (yellow) must be installed into the HOUSING (**see figure), white side up, aligning the slots on the bobbin with the ridges inside the threaded housing. The bobbin will slide in easily if installed correctly.

STEP 7: Install cap by screwing clockwise until it meets the housing shoulder. **Note:** No gap between the cap and the housing shoulder.

STEP 8: Check the new cylinder to be sure it has not been punctured.

IMPORTANT! Install the bobbin and cap before installing a new cylinder.

STEP 9: Install new cylinder by engaging the cylinder threads with the inflator threads. Turn cylinder clockwise till a firm seal is achieved.

WARNING: PFD WILL ONLY INFLATE IF CYLINDER IS TURNED TO FULL STOP.

STEP 10: Check to be sure service indicator is **GREEN**.

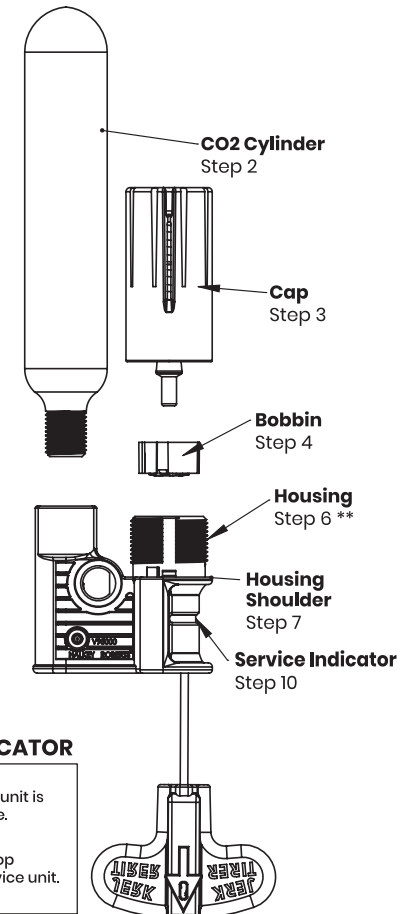

- Re-pack the life jacket according to the life jacket manufacturers instructions.
- When not in use, store the life jacket in a cool, dry place out of direct sunlight.